



LATA

## LATA URBAN FURNITURE PRODUCT LINE

Consultation, Design Services, Engineering, Fabrication, Installation.

[www.sd-ind.com](http://www.sd-ind.com) | [sales@sd-ind.com](mailto:sales@sd-ind.com) | 212-348-8000

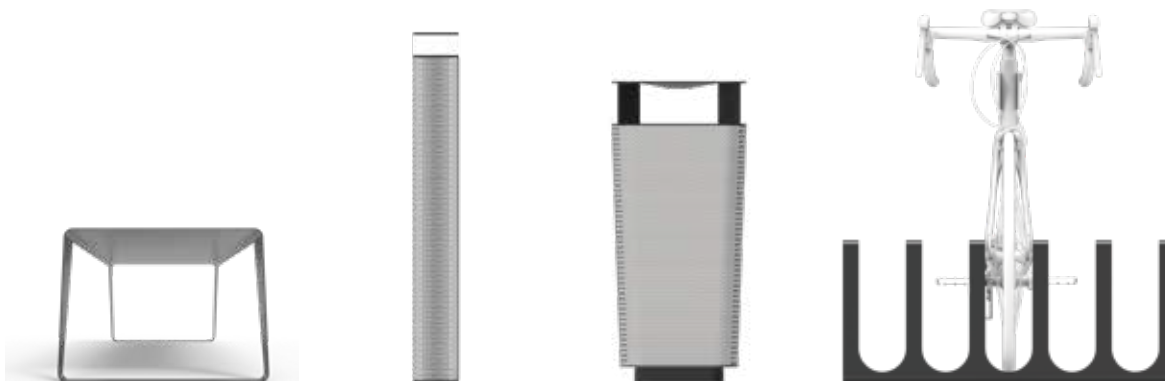

LATA

01

## LATA

### BEND. REPEAT. RESHAPE THE CITY.

Lata is a product line defined by the repetition of folded steel geometries. Every element is fabricated from laser-cut sheet metal, bent precisely to form rigid, sculptural structures. The line reflects clarity in form and resilience in use, ideal for high-traffic public spaces. Lata expresses strength through folded simplicity, with clean silhouettes that are both structural and iconic.

#### Key Features

##### Monomaterial Construction:

All pieces are made from steel sheets, cut and folded to define each product. No unnecessary additions. Just clean, controlled geometry.

##### Consistent Design Language:

Benches, bins, and racks all share the same formal expression: sharp folds, negative space, and grounding symmetry.

##### Weather-Resistant Finish:

Powder coating or hot-dip galvanizing protects every unit

from corrosion and wear in outdoor environments.

##### Modular Logic:

The bike rack and bench components can be repeated seamlessly. Designed for scalability in urban planning.

##### Structural Simplicity:

Each element is self-supporting. No hidden frames. The structure is the shape.



## LATA BENCH

### GEOMETRY MADE USEFUL

The Lata Bench blends crisp lines and industrial rigor into a fully welded steel body. Its slanted legs and folded planes offer visual lightness without compromising structure. Whether with or without a backrest, the design reads as a single continuous gesture—clean, compact, and contemporary.



# LATA BENCH

## GEOMETRY MADE USEFUL

### Key Features

#### Single-Sheet Structure:

Formed from a single laser-cut and folded steel plate, the Lata Bench reduces welds and simplifies assembly while maintaining structural strength.

#### Backrest Option:

Available in both backless and backed versions, adapting to plazas, corridors, or public platforms.

#### Welded Minimalism:

Its angular profile, discreet feet, and precise edges reflect high fabrication control and modern appeal.

#### Powder-Coated Durability:

Finished in outdoor-grade powder coating to endure high foot traffic, sun, and rain.

#### Clean Installation:

Designed for anchor bolting through concealed base flanges, ensuring visual continuity with the ground plane.

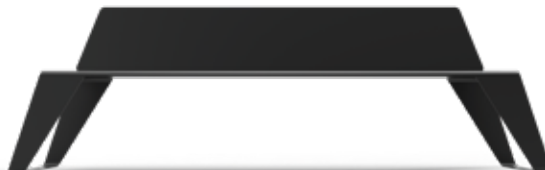

## LATA BIN

### PRECISION AND CLARITY.

The Lata Bin combines structural refinement with lightweight construction. Its perforated steel shell and flared aluminum top create a strong urban presence while maintaining ventilation and cleanliness. Engineered with high-frequency usage in mind, the Lata Bin resists impact, simplifies waste disposal, and integrates into architectural environments without excess ornament.

#### Key Features

##### Perforated Steel Skin:

A single folded steel body features precision laser-cut perforations for airflow, visibility, and waste management control.

##### Tapered Geometry:

The flared profile enhances rigidity while offering an easy throw-in angle from any direction, reducing missed disposals.

##### Top Frame and Funnel:

The top plate includes an inward-sloped funnel and internal mesh filter for liquids and debris, manufactured as a separate die-cut component for simplified maintenance.

##### Base Plate Integration:

Hidden fixing points below the internal can liner ensure vandal resistance and seamless installation.

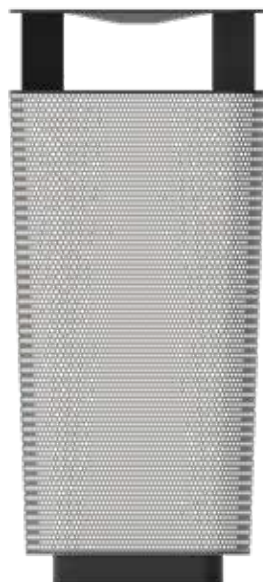

# LATA BIKE RACK

## SIMPLICITY WITH BOLD STANCE

The Lata bike rack is a bold, minimal solution for secure urban bike parking. Designed with continuity in mind, its form echoes the bench and bin within the same line, creating a cohesive streetscape presence. Each U-shaped loop is precision cut and formed from a single steel sheet, ensuring strength with no unnecessary components.

### Key Features

#### Unified Geometry:

The rack's profile maintains visual harmony with other Lata pieces, reinforcing the identity of the line in public space applications.

#### Steel Efficiency:

Crafted from folded steel sheets, the rack balances visual weight with structural rigidity, eliminating the need for welds or added frames.

#### Secure and Modular:

Each slot supports the front wheel while allowing frame locking. Configurable in modules to adapt to various capacities.

#### Durable and Low-Maintenance:

Finished with corrosion-resistant coatings, the rack performs in all climates with minimal upkeep.

#### Fast Installation:

Flat base design allows for quick anchoring to concrete or pavers, reducing labor costs on site.



LATA BIKE RACK

05



# LATA BOLLARD

## DESIGNED TO BE NOTICED AND TO LAST

The Lata Bollard is a tall, commanding presence designed to mark, protect, and define public space with confidence. Fabricated from perforated steel sheets, its light-permeable skin contrasts with a solid square steel top, giving the piece a dual character—visually lightweight but physically robust.

### Key Features:

#### Perforated Steel Body:

The cylindrical body is fabricated from finely perforated metal, providing visual texture and allowing interior lighting when required.

#### Square Steel Cap:

The upper plate is laser-cut and finished to close the volume and serve as a light diffuser or architectural accent.

#### Structural and Aesthetic Role:

Beyond its function as a vehicle or pedestrian barrier, the Lata Bollard contributes to the project's visual rhythm, offering a refined vertical gesture.

#### Lighting Integration Ready:

Its internal cavity and pattern make it suitable for integrated lighting solutions without additional accessories.

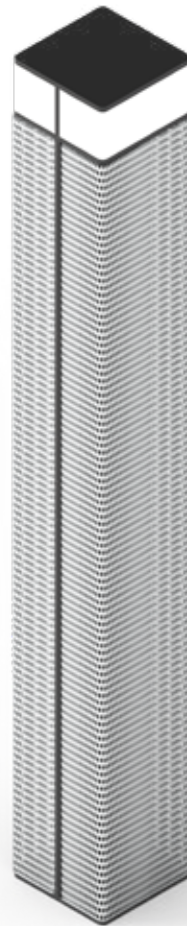

LATA BOLLARD

06

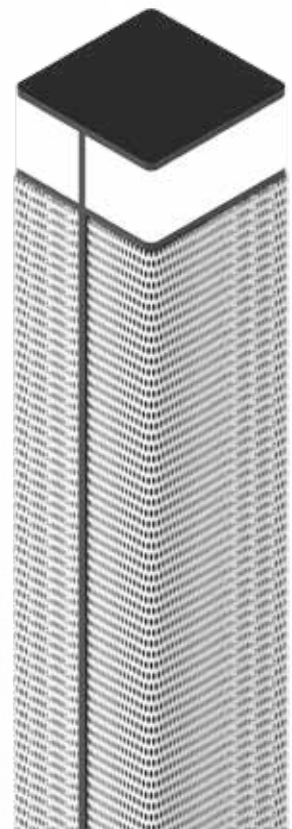



# SDI LATA URBAN FURNITURE PRODUCT LINE

## CONTACT

### HEADQUARTERS

250 Pehle Ave, Ste 200, Saddle Brook, NJ 07663

### OFFICE

50 Harrison St, Ste 214, Hoboken, NJ 07030

### FACTORY

213 Porter Rd, Conroe, TX 77301



[www.sd-ind.com](http://www.sd-ind.com)



[sales@sd-ind.com](mailto:sales@sd-ind.com)



212-348-8000